

## AIR DEFLECTOR - MAINTENANCE PRACTICES

### 1. General

- A. A removable cargo door and air deflector may be installed on the airplane. The air deflector is installed to lessen drag on the airplane when airplane is flown with the cargo door removed.

### 2. Upper Cargo Door Removal/Installation

- A. Remove Upper Cargo Door (Refer to Figure 201).
  - (1) Remove cotter pin and pin securing pull strap to lower door.
  - (2) Remove safety clips from gas springs and remove gas springs from ball studs.
  - (3) Remove cotter pins (1) and pins (3) from hinges (2) and remove door.

**NOTE: Remove lower cargo door.**

- B. Install Upper Cargo Door (Refer to Figure 201 ).
  - (1) Position door and install pins (3) in hinges (2), then install cotter pins (1).
  - (2) Install gas springs on ballstuds and install safety clips.

**NOTE: Install lower cargo door.**

- (3) Connect pull strap to lower door using pin and cotter pin.

### 3. Air Deflector Removal/Installation

- A. Remove Air Deflector (Refer to Figure 201).
  - (1) Remove nut (19) and screw (20).
  - (2) Remove screw (18) and washer (17).
  - (3) Remove cotter pin (1) and pin (3).
  - (4) Remove cotter pins (13), washer (12), pins (10), and remove deflector (6).

- B. Install Air Deflector (Refer to Figure 201).
  - (1) Position deflector (6) and install pins (3) and (10).
  - (2) Install washers (12) and cotter pins (13).
  - (3) Install cotter pin (1).
  - (4) Install screw (20) and nut (19).
  - (5) Install washer (17) and screw (18).

Figure 201 : Sheet 1 : Air Deflector Installation

A22258

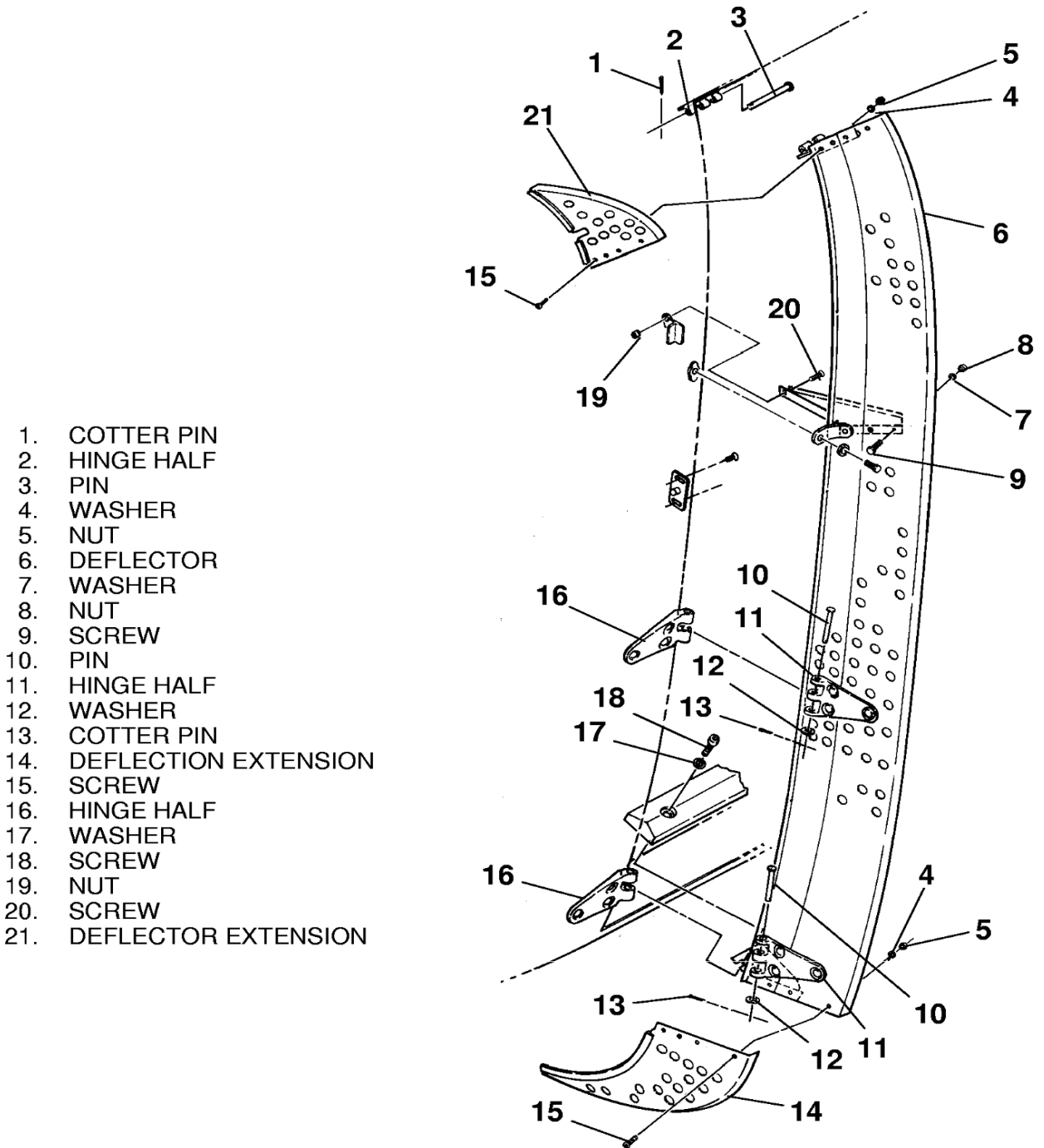

- 1. COTTER PIN
- 2. HINGE HALF
- 3. PIN
- 4. WASHER
- 5. NUT
- 6. DEFLECTOR
- 7. WASHER
- 8. NUT
- 9. SCREW
- 10. PIN
- 11. HINGE HALF
- 12. WASHER
- 13. COTTER PIN
- 14. DEFLECTION EXTENSION
- 15. SCREW
- 16. HINGE HALF
- 17. WASHER
- 18. SCREW
- 19. NUT
- 20. SCREW
- 21. DEFLECTOR EXTENSION

AIRPLANES 20800089 AND ON  
 AND 208B0214 AND ON

26142020A